

**START-UP TIME DELAY SELECT**  
 TO ADD A 5 SECOND TIME DELAY ON THE ENGINE START-UP (REMOTE START ONLY), CUT THE "TDJ" JUMPER WIRE.

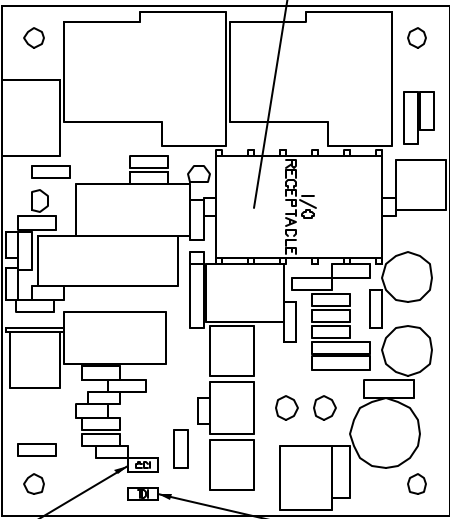

**CRANKING SELECT**  
 THE REMOTE START/STOP BOARD IS SHIPPED CONFIGURED FOR A SINGLE CRANK PERIOD OF 30 SECONDS. TO CONVERT TO CYCLE CRANKING, CUT THE "CCL" JUMPER WIRE AS SHOWN.

- NOTES:**
- 1.) CUSTOMER TO SUPPLY AMP 1-480710-1 PLUG WITH (15) 350550-1 SOCKET CONNECTORS. VIEW SHOWN FROM BACK (WIRING END) OF PLUG.
  - 2.) MAGNETO GROUND MUST BE KEPT SEPARATE FROM CONTROL GROUND (PIN 13.)
- \* MAG, CS, AND FS ARE RELAY CONTACTS LOCATED WITHIN THE ENGINE CONTROL.

**Bauchette Electronics, Inc.**  
 111325 County Highway Y Clinton, WI 54829

TITLE	CONNECTION DIAGRAM	REV	RSS4
DATE	12/26/98	DRN BY	DSB
BY	DSB	CHK	TJB
APP'D		DATE	
			NOTE

E205-1